

## Mass Decon system 445

The Mass Decontamination system 445 is designed for the simultaneous decontamination of four lines of people. In case of serious injury, casualties on stretchers can be led through the decontamination system as well. The heated air and clean water supply will enter the tent in the opposite direction of the decontamination flow.

Mass Decontamination System 445		
	Capacity	Consumption
Decontamination	80 persons / hour	
Water	12 L / person	
Diesel		10.1 L / hour
Electricity		2,0 kW
1 Shower area	2m x 1,3m	

### Advantages:

- 4 integrated shower systems
- Easily storable and transportable
- Ready for use in less than 10 minutes
- Decontamination of 80 persons per hour
- Separate reception and checking areas
- Separate dressing and undressing areas

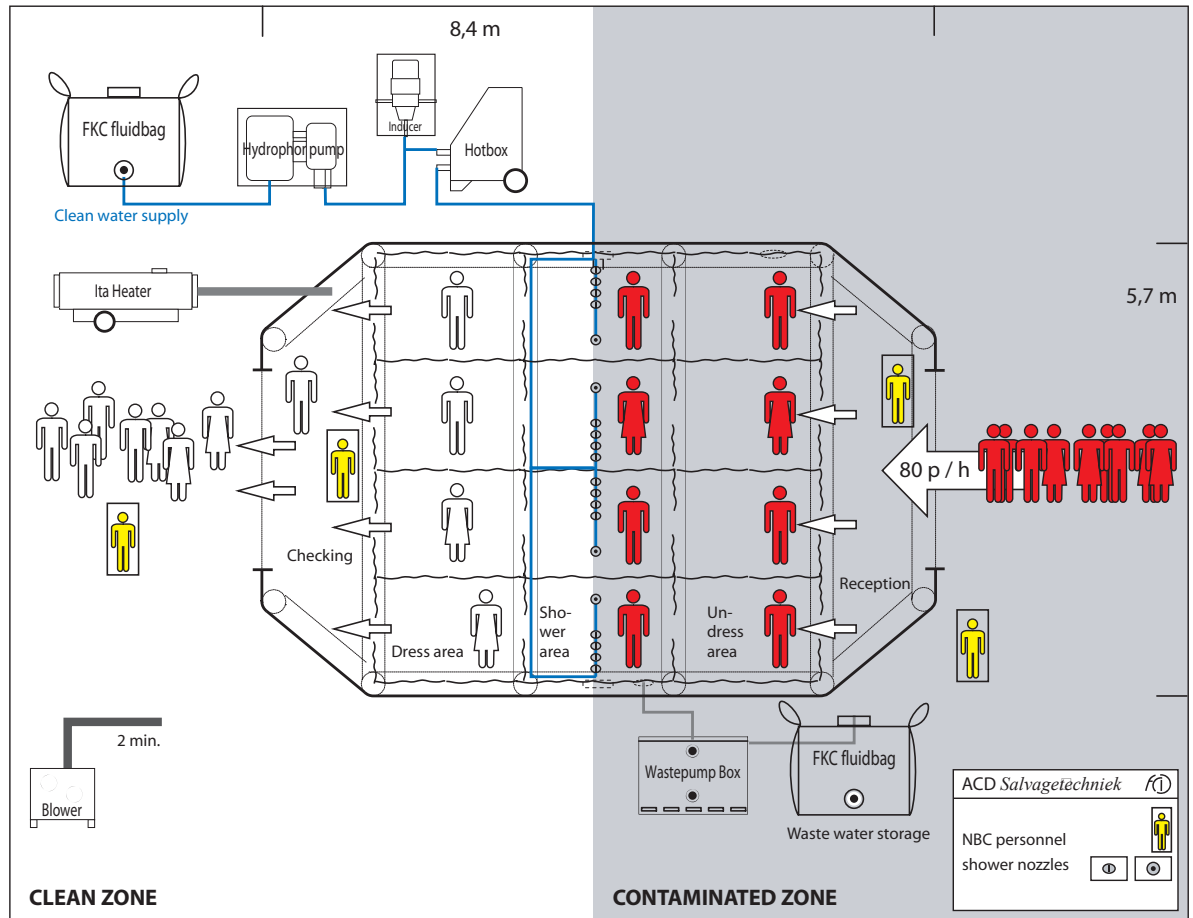

Name	ACD art. no.	Description	#	L x W x H (cm)	Weight (kg)
Airshelter IV	AIR200-4	Inflatable shelter (by BA cilinder or blower)	1	840 x 570 x 295	92
Integrated Shower	AFW114A	Waiting, undress, shower, dress, chekcing compartments	1	100 x 95 x 20	20
FKC Fluidbag 500	AFW120A	Foldable reservoir for clean water or waste water	8	70 x 85 x 86	3
Hydrophor pump	AFZ710	Water supply pump, providing pressure to the system	1	62 x 55 x 32	34
Hotbox 200	ACD200	Water heating, automatically controlled temperature	1	63 x 70 x 96	80
Inducer	ACD201	For the accurate mixing of decontaminants, detoxificants or desinfectants, independent from flow and waterpressure	1	14 x 20 x 47	2
Blower B	AIR430	Inflating and deflating of large air structures	1	28 x 32 x 33	8
AIR 25 Heater	AIR500	Providing heated air to the shelter	1	130 x 52 x 85	76
Wastepump box	AFZ720-C	Drainage of decontamination wastewater into a reservoir	2	41 x 36 x 35	9
Lighting	AIR600-B	Lightweight lighting system	4	65 x 14,5 x 19	3,5
Decon brush	ACD112M	Brushes used for the pre-decontamination	4	115 x 10 x 10	1
Generator		3,2 kVA	1		